



CLASSICA
Signature Homes

The French Cottage Montecito
Riverchase 1-14



Discuss with Sales Manager to get specifics on the home to be purchased. Photo reflects the color and finishes for this custom home.

CUSTOM FLOORPLAN

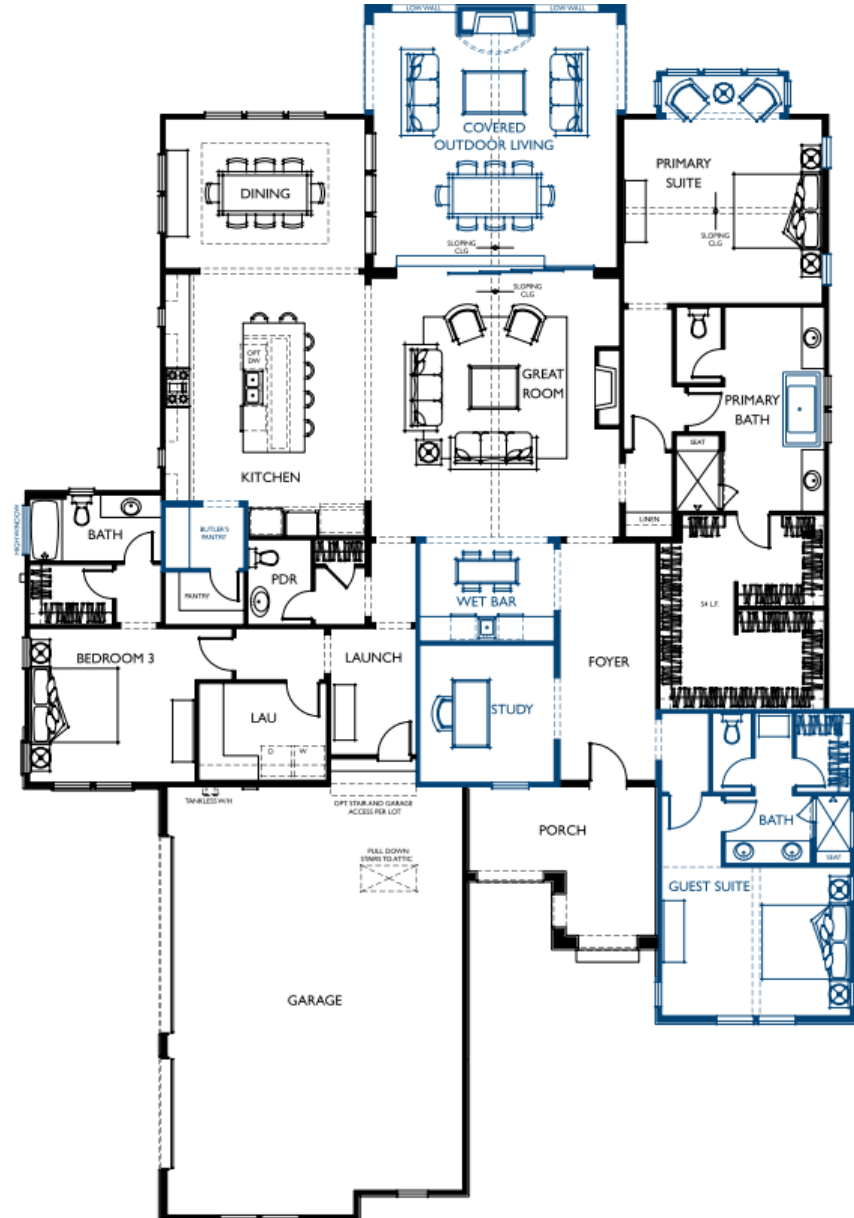

Elevation (exterior rendering of home) and floorplan are provided for illustrative use only and may vary from actual home built. Details, including, but limited to, windows, roofing, colors, closets or other items may vary. Discuss with Sales Manager to get specifics on the home to be purchased.

KITCHEN PERIMETER



Wood Hood

- ### LAYOUT
- Cabinets to Ceiling (*Glass Only in Hutches*)
 - Hutches with Glass
 - 2 Sets of Drawer Stacks
 - Spice Pull Out & Canister Pull Out, Each side of Range

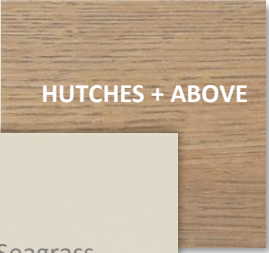
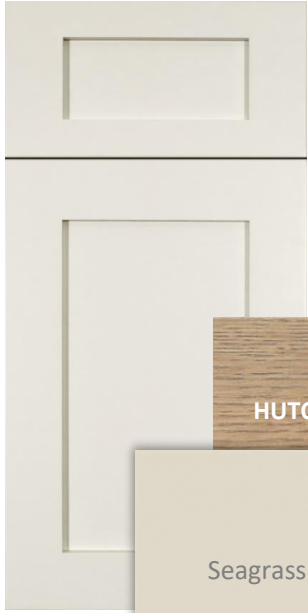

HUTCHES + ABOVE



Seagrass



BACKSPLASH

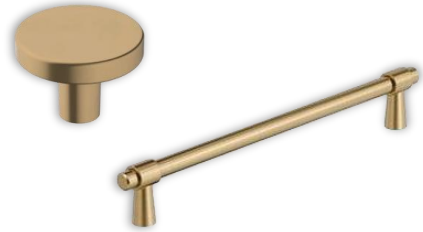

COUNTERTOPS



Note – For illustrative purposes and to help represent the selections made, shown in detail on the Classica Client Selection Sheets for this home. Selections may change and such changes might not be reflected on these representation sheets. Further, there is no way to accurately ensure colors are printed correctly on these sheets and should not be relied upon.

KITCHEN ISLAND



Vertical V-Groove

*Painted Accessible Beige



Note – For illustrative purposes and to help represent the selections made, shown in detail on the Classica Client Selection Sheets for this home. Selections may change and such changes might not be reflected on these representation sheets. Further, there is no way to accurately ensure colors are printed correctly on these sheets and should not be relied upon.

APPLIANCES



36" Range



Microwave

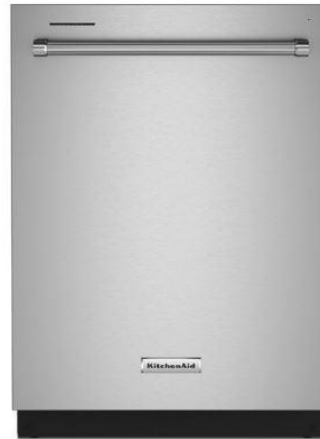

Dishwasher



Fridge

Note – For illustrative purposes and to help represent the selections made, shown in detail on the Classica Client Selection Sheets for this home. Selections may change and such changes might not be reflected on these representation sheets. Further, there is no way to accurately ensure colors are printed correctly on these sheets and should not be relied upon.

BUTLER'S PANTRY



Vertical Square Groove
Trim above Base
Cabinets

Note – For illustrative purposes and to help represent the selections made, shown in detail on the Classica Client Selection Sheets for this home. Selections may change and such changes might not be reflected on these representation sheets. Further, there is no way to accurately ensure colors are printed correctly on these sheets and should not be relied upon.

WET BAR 1st FLOOR



COUNTERTOPS



Glass Rinser

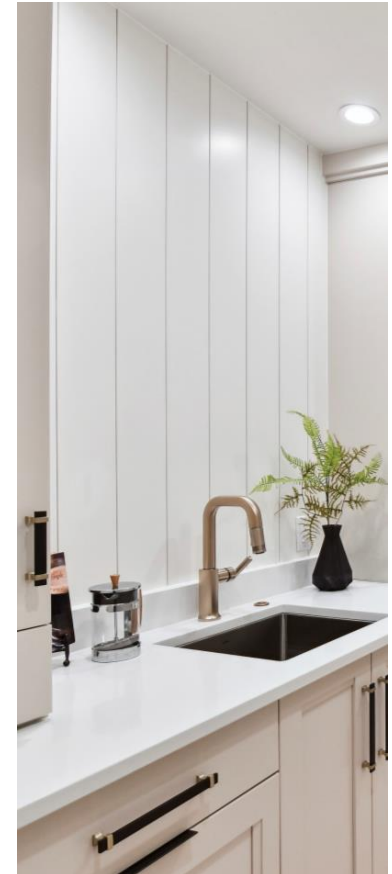

Vertical Square Groove
Trim above Base Cabinets

Note – For illustrative purposes and to help represent the selections made, shown in detail on the Classica Client Selection Sheets for this home. Selections may change and such changes might not be reflected on these representation sheets. Further, there is no way to accurately ensure colors are printed correctly on these sheets and should not be relied upon.

GREAT ROOM



Lamach White Stone
Mantel As Shown (Painted)



HARDWOOD

Note – For illustrative purposes and to help represent the selections made, shown in detail on the Classica Client Selection Sheets for this home. Selections may change and such changes might not be reflected on these representation sheets. Further, there is no way to accurately ensure colors are printed correctly on these sheets and should not be relied upon.

PRIMARY BATHROOM



COUNTERTOPS



SHOWER FLOOR

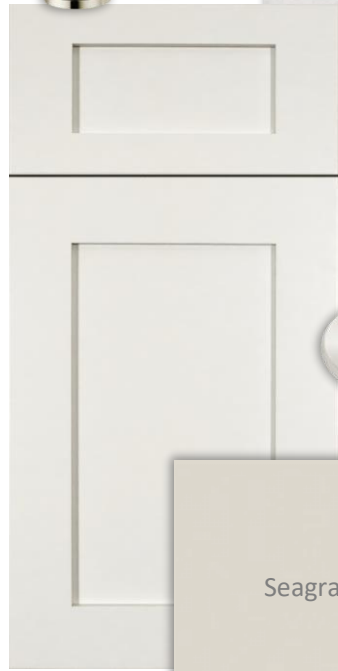

Seagrass



WALL & FLOOR TILE



Frameless Shower Door

Note – For illustrative purposes and to help represent the selections made, shown in detail on the Classica Client Selection Sheets for this home. Selections may change and such changes might not be reflected on these representation sheets. Further, there is no way to accurately ensure colors are printed correctly on these sheets and should not be relied upon.

PRIMARY SUITE VESTIBULE

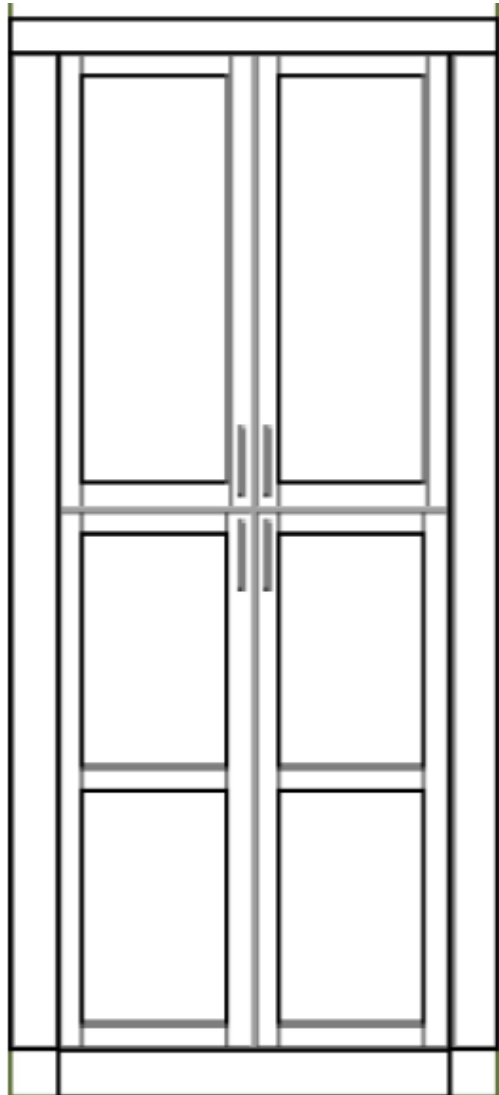

Linen Cabinet located at Primary Vestibule for Decorative Built-In Storage
**See floor plan for Location*



Note – For illustrative purposes and to help represent the selections made, shown in detail on the Classica Client Selection Sheets for this home. Selections may change and such changes might not be reflected on these representation sheets. Further, there is no way to accurately ensure colors are printed correctly on these sheets and should not be relied upon.

GUEST VIP SUITE

HORIZONTAL 1X4 BATTENS



HARDWOOD

GUEST VIP BATH



COUNTERTOPS



WALL TILE



TILE SHOWER FLOOR



PORCINI



FLOOR TILE

*Polished

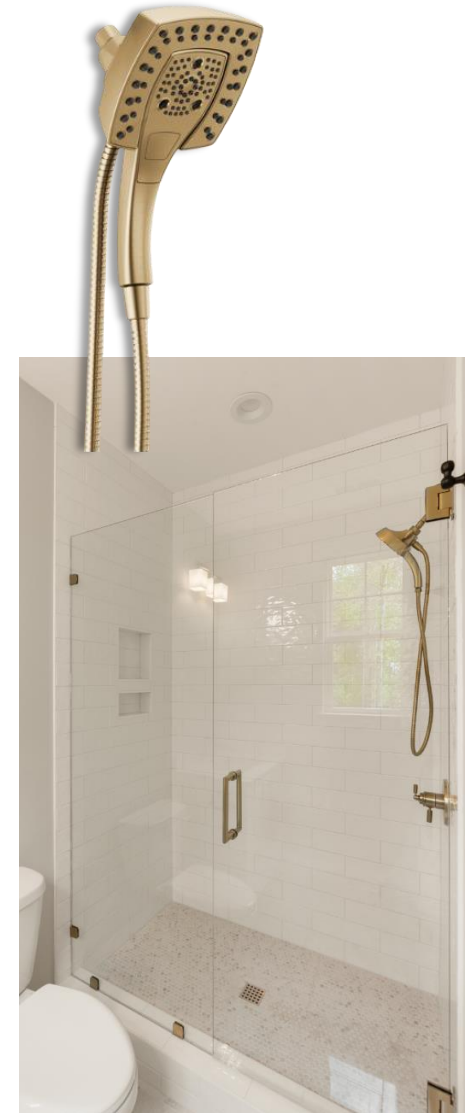

Frameless Shower Door

Note – For illustrative purposes and to help represent the selections made, shown in detail on the Classica Client Selection Sheets for this home. Selections may change and such changes might not be reflected on these representation sheets. Further, there is no way to accurately ensure colors are printed correctly on these sheets and should not be relied upon.

BEDROOM 3

VERTICAL 1X2 BATTENS



CARPET

Note – For illustrative purposes and to help represent the selections made, shown in detail on the Classica Client Selection Sheets for this home. Selections may change and such changes might not be reflected on these representation sheets. Further, there is no way to accurately ensure colors are printed correctly on these sheets and should not be relied upon.

BEDROOM 3 FULL BATH

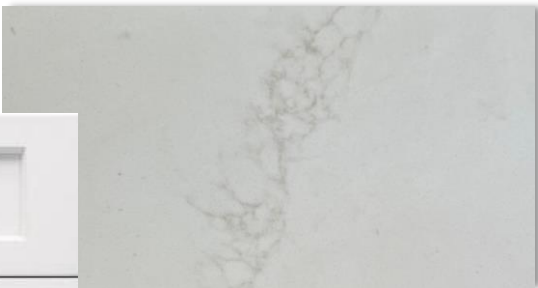

COUNTERTOPS

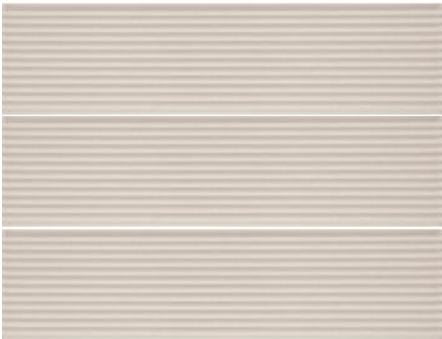

WALL TILE
*2x8
Fluted

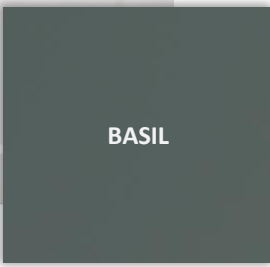

BASIL



FLOOR TILE



Tub/Shower

Note – For illustrative purposes and to help represent the selections made, shown in detail on the Classica Client Selection Sheets for this home. Selections may change and such changes might not be reflected on these representation sheets. Further, there is no way to accurately ensure colors are printed correctly on these sheets and should not be relied upon.

POWDER ROOM

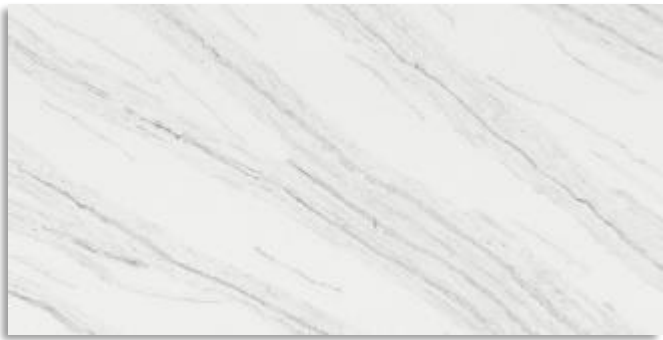

COUNTERTOPS



HARDWOOD



Note – For illustrative purposes and to help represent the selections made, shown in detail on the Classica Client Selection Sheets for this home. Selections may change and such changes might not be reflected on these representation sheets. Further, there is no way to accurately ensure colors are printed correctly on these sheets and should not be relied upon.

LAUNDRY ROOM

1st Floor



COUNTERTOPS



Base Cabinets with Sink



HARDWOOD

Note – For illustrative purposes and to help represent the selections made, shown in detail on the Classica Client Selection Sheets for this home. Selections may change and such changes might not be reflected on these representation sheets. Further, there is no way to accurately ensure colors are printed correctly on these sheets and should not be relied upon.

INTERIOR TRIM

Coffered Ceiling at Study



Cedar Ceiling Beams at Foyer x4



Note – For illustrative purposes and to help represent the selections made, shown in detail on the Classica Client Selection Sheets for this home. Selections may change and such changes might not be reflected on these representation sheets. Further, there is no way to accurately ensure colors are printed correctly on these sheets and should not be relied upon.

INTERIOR TRIM



1x8 Baseboards
Signature Trim Package
Logan Doors



Interior Door Hardware

Note – For illustrative purposes and to help represent the selections made, shown in detail on the Classica Client Selection Sheets for this home. Selections may change and such changes might not be reflected on these representation sheets. Further, there is no way to accurately ensure colors are printed correctly on these sheets and should not be relied upon.

PANTRY + CLOSETS



MELAMINE SHELVING

TO BE INSTALLED THROUGHOUT THE ENTIRE
HOUSE PANTRY & CLOSETS

*Layouts are pre-determined with **no available changes**.
Please discuss with Sales or Design for further information.



*Not representative of exact layouts or floorplan. For visual purposes only.

Note – For illustrative purposes and to help represent the selections made, shown in detail on the Classica Client Selection Sheets for this home. Selections may change and such changes might not be reflected on these representation sheets. Further, there is no way to accurately ensure colors are printed correctly on these sheets and should not be relied upon.

FLOORING & PAINT



HARDWOOD
Harbourlin – Sand Dollar Oak



CARPET
Sonar II - Vanilla

*See Selections Packet For Flooring Locations



*See Selections Packet For Locations

COVERED OUTDOOR LIVING



Tongue & Groove Ceiling Detail



Travertine Pavers



Fireplace

Note – For illustrative purposes and to help represent the selections made, shown in detail on the Classica Client Selection Sheets for this home. Selections may change and such changes might not be reflected on these representation sheets. Further, there is no way to accurately ensure colors are printed correctly on these sheets and should not be relied upon.

EXTERIOR DETAILS



Flagstone Pavers
At Front Porch



Epoxy Coating at
Garage Floor

*Color not representative of selection